



PARA LIGHT ELECTRONICS CO., LTD.

4F, No.1, Lane 93, Chien Yi Road, Chung Ho City, Taipei, Taiwan, R.O.C.

Tel: 886-2-2225-3733

Fax: 886-2-2225-4800

E-mail: para@para.com.tw

<http://www.para.com.tw>

DATA SHEET

PART NO. : L-955SRC-TR

REV : A / 2

CUSTOMER'S APPROVAL : _____

DCC : _____

DRAWING NO. : DS-31-03-0065

DATE : 2004-09-24

Page : 1

PACKAGE DIMENSIONS

Note:

- 1.All Dimensions are in millimeters.
- 2.Tolerance is $\pm 0.10\text{mm}$ (0.004 ") Unless otherwise specified.
- 3.Lead spacing is measured where the leads emerge from the package.
- 4.Specification are subject to change without notice

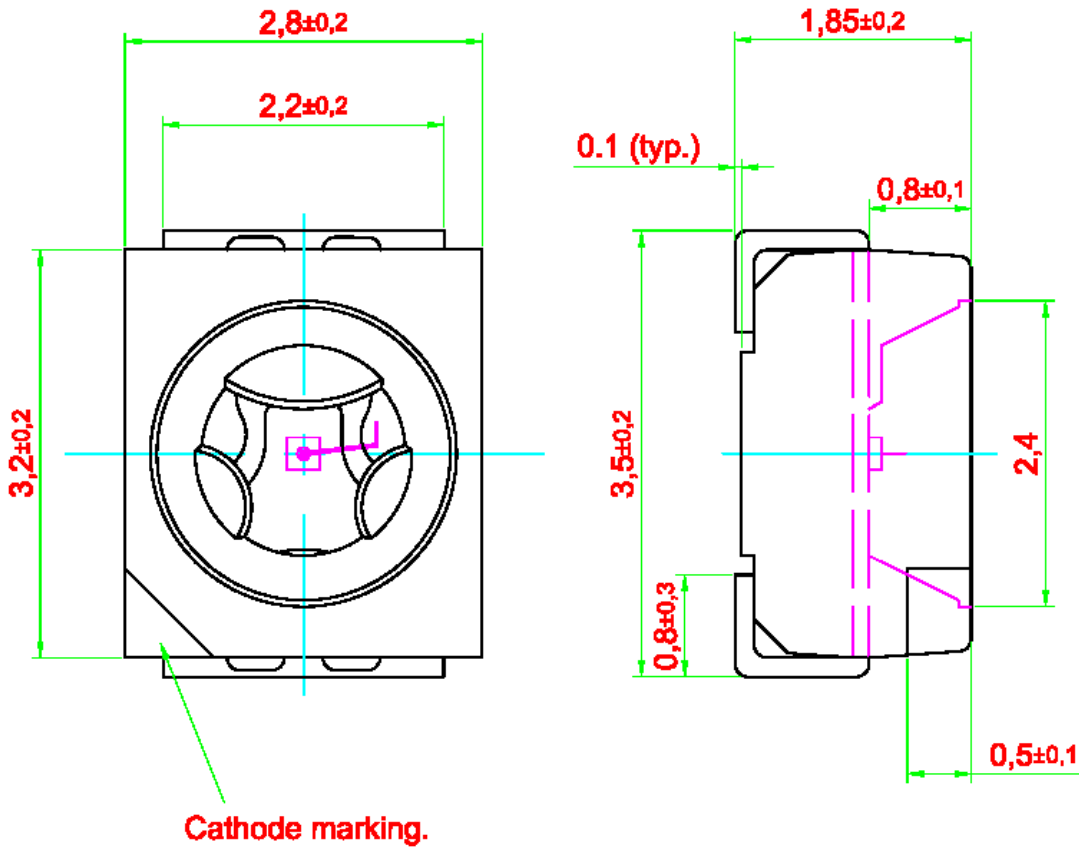
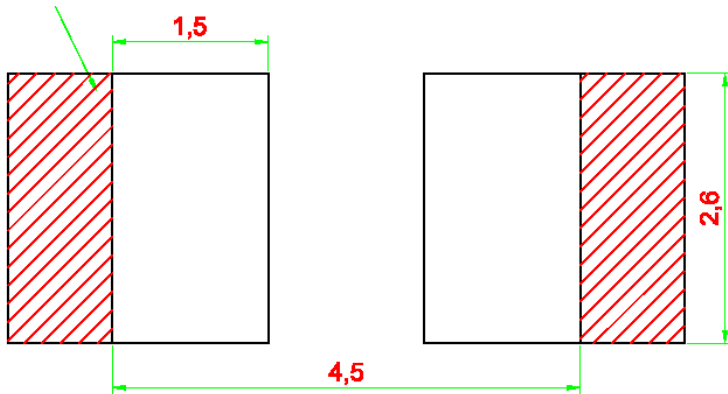



3.2*2.8*1.9 mm SMD LED LAMP

L-955SRC-TR

REV:A / 2

FEATURES

- * HIGH BRIGHTNESS SURFACE MOUNT LED
- * BASED ON INGAN TECHNOLOGY
- * 120° VIEWING ANGLE
- * SMALL PACKAGE OUTLINE (L*W*H)OF 2.8*3.2*1.9MM)
- * QUALIFIED ACCORDING TO JEDEC MOISTURE SENSITIVITY LEVEL 2
- * COMPATIBLE TO BOTH IR REFLOW SOLDERING AND TTW SOLDERING

CHIP MATERIALS

- * Dice Material GaAsP
- * Light Color : SUPER RED
- * Lens Color : WATER CLEAR

ABSOLUTE MAXIMUM RATING : (Ta = 25°C)

SYMBOL	PARAMETER	SUPER RED	UNIT
PAD	Power Dissipation Per Chip	70	mW
VR	Reverse Voltage Per Chip	5	V
IAF	Continuous Forward Current Per Chip	30	mA
IPF	Peak Forward Current Per Chip (Duty—0.1,1KHz)	60	mA
—	Derating Linear From 25°C Per Chip	0.40	mA/°C
Topr	Operating Temperature Range	-40°C to 100°C	
Tstg	Storage Temperature Range	-40°C to 100°C	

Lead Soldering Temperature { 1.6mm(0.063 inch) From Body } 240°C For 10 Seconds

ELECTRO-OPTICAL CHARACTERISTICS : (Ta = 25°C)

SYMBOL	PARAMETER	TEST CONDITION	MIN.	TYP.	MAX.	UNIT
VF	Forward Voltage	IF = 20mA		1.8	2.2	V
IR	Reverse Current	VR = 5V			10	µA
λD	Dominant Wavelength	IF = 20mA		640		nm
Δλ	Spectral Line Half-Width	IF = 20mA		20		nm
2θ1/2	Half Intensity Angle	IF = 20mA		120		deg
Iv	Luminous Intensity	IF = 20mA	18		45	mcd

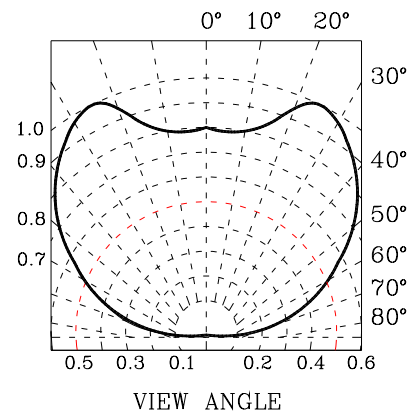
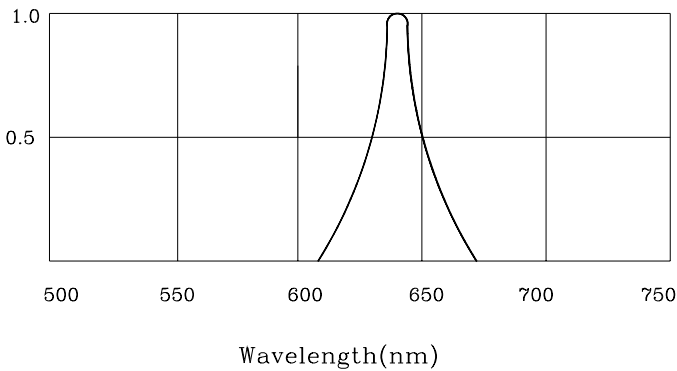
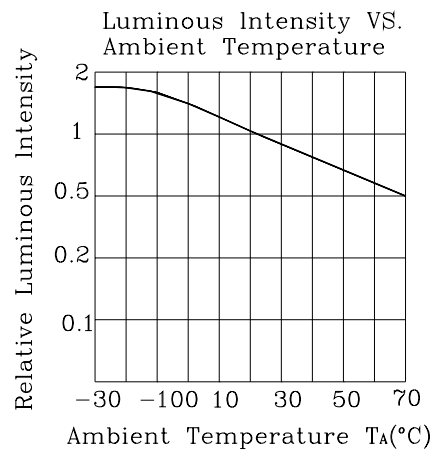
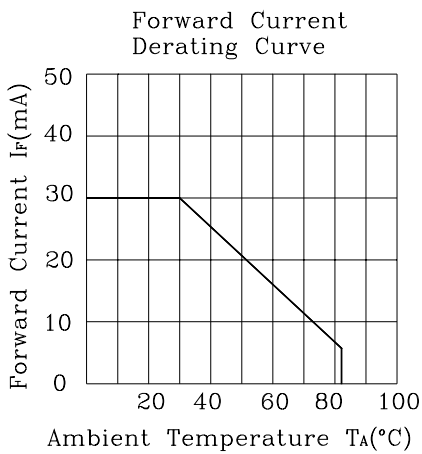
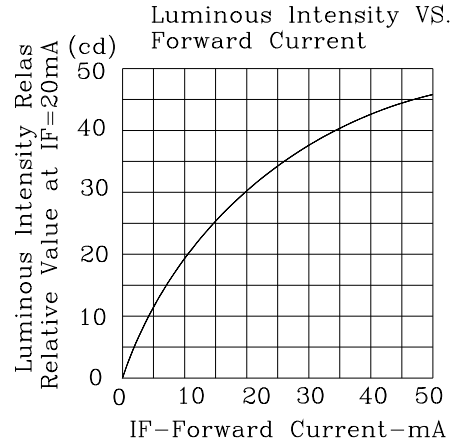
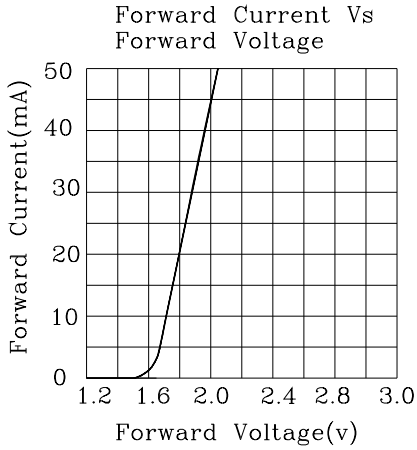

Recommended IR-reflow Soldering Profile (acc. to IPC 9501).

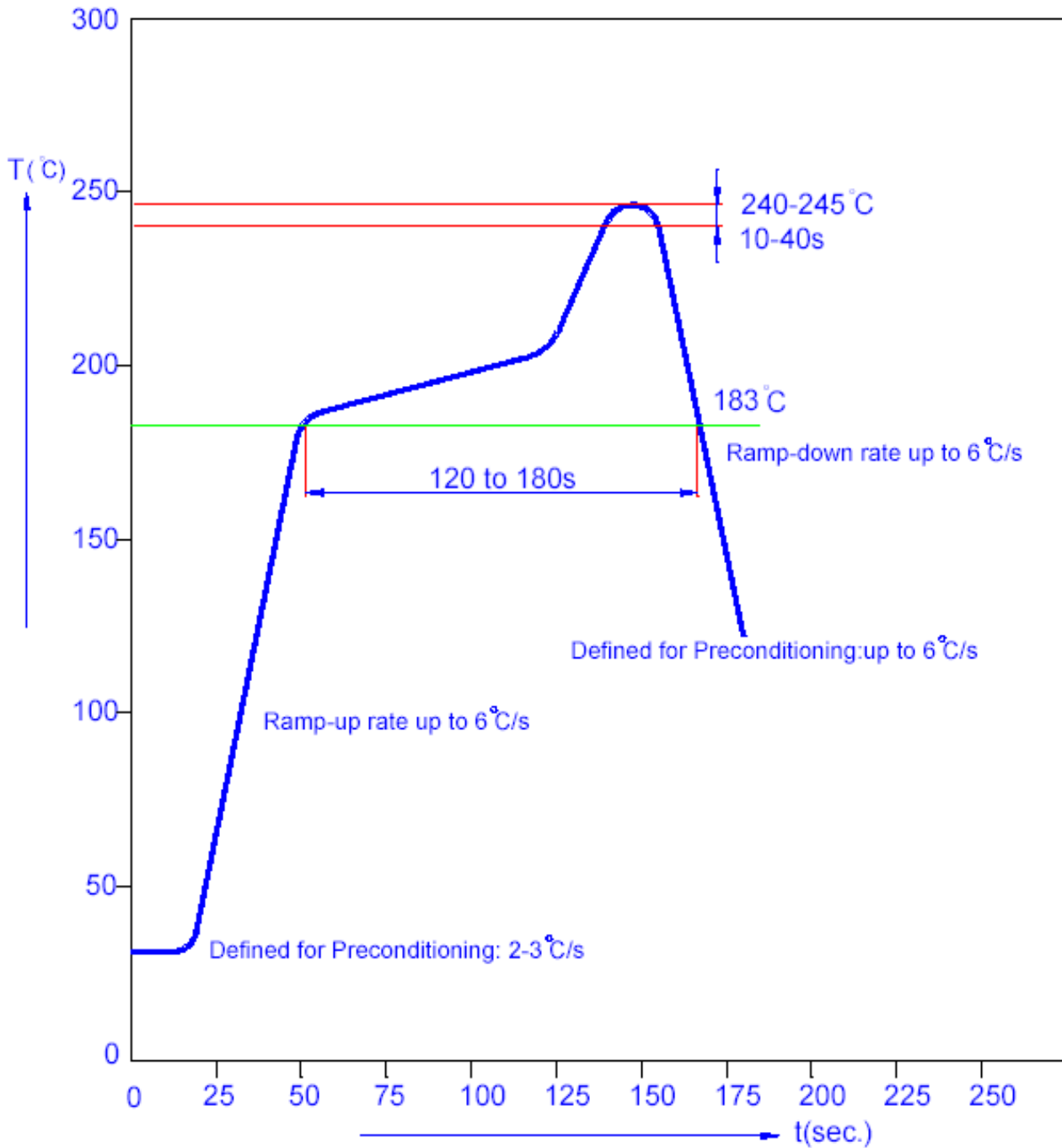

Taping And Orientation.

Reels come in quantity of 2000 units.

Reel diameters is 180 mm .

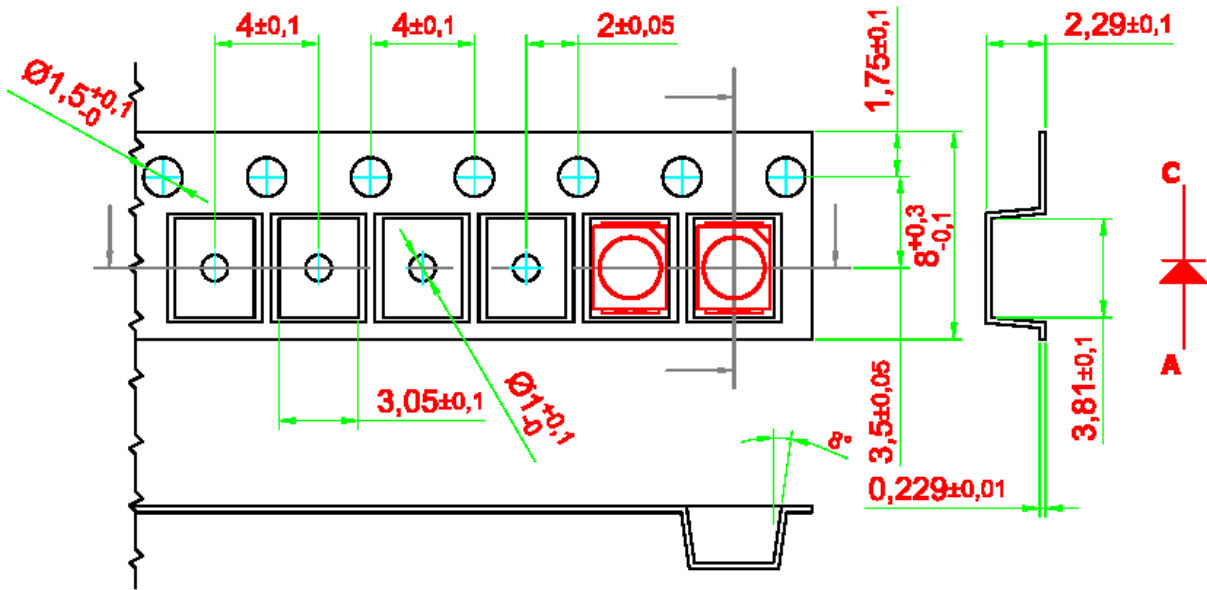

200 mm min. for Ø180 reel.
200 mm min. for Ø330 reel.

480 mm min. for Ø180 reel.
960 mm min. for Ø330 reel.

